

**Quick-Start Operating Guide**  
**Sole Cleaner**

Document No. 1800-49

© Copyright 2012 Terra Universal Inc. All rights reserved. • Revised September 2024



*Your Comprehensive  
 Equipment Source*





# Quick-Start Operating Guide Sole Cleaner

© Copyright 2012 Terra Universal Inc. All rights reserved. • Revised Sept. 2024 • Document No. 1800-49

## Proprietary Notice

This manual pertains to proprietary devices manufactured by Terra Universal, Inc. Neither this document nor any portion of it may be reproduced in any way without prior written permission from Terra Universal.

Terra Universal makes no warranties applying to information contained in this manual or its suitability for any implied or inferred purpose. Terra Universal shall not be held liable for any errors this manual contains or for any damages that result from its use.

## Safety Notice

A thorough familiarity with all operating guidelines is essential to safe operation of the product. Failure to observe safety precautions could result in poor performance, damage to the system or other property, or serious bodily injury or death.



CAUTION

Cautions are used when failure to observe instructions could result in significant damage to equipment.

The following symbols are intended to call your attention to two levels of hazard involved in operation:



WARNING

Warnings are used when failure to observe instructions or precautions could result in injury or death.

The information presented here is subject to change without notice.

## Introduction

This manual provides information on operating and maintaining your Terra Sole Cleaner. By studying it carefully, you can be assured of a long, efficient service life from the unit.

## 1.0 Equipment Description

Terra Universal's Sole Cleaner features an adhesive surface that seizes particles from the bottoms of shoes and carts as they pass into a changing room or cleanroom.

It incorporates a microprocessor-controlled transport mechanism that automatically replaces the sticky film surface as it becomes soiled. Instead of individual mats, which must be cleaned or peeled off, the Sole Cleaner uses a continuous sheet of adhesive mat material mounted on a cartridge roll. An infrared beam monitors passing feet, and a counter displays total passes. When the total count exceeds the threshold you select, the transport system automatically unrolls a new sheet of sticky surface and resets the counter.

Made of stainless steel, the Sole Cleaner features safety handrails and a low, sloped profile that won't pose a tripping hazard. Its wide passage-way allows 36" of side-to-side clearance. The sticky film rests on a semi-flexible support pad that protects against rips, eliminates slippage, and enhances particle pick-up.

The side housings swing up to permit access to the mat cartridges and the transport mechanism, which uses a minimal number of moving parts to enhance system reliability. The solid-state microprocessor includes an LCD readout of the number of passes. Multiple preset limits can be stored to allow simple system updating if the Sole Cleaner is moved from one location to another. The UL-listed take-up motor includes a safety overload shut-off that halts mat motion if an object (or person) is on the Sole Cleaner.

The Sole Cleaner requires no special installation—simply place it directly on the floor, plug it in, enter the desired number of passes, and it's ready for operation. It can be moved from one location to another, and requires no maintenance other than occasional cartridge replacement.





# Quick-Start Operating Guide Sole Cleaner

© Copyright 2012 Terra Universal Inc. All rights reserved. • Revised Sept. 2024 • Document No. 1800-49

Each 180-foot roll typically yields about 50 surface changes.

Installation work and electrical wiring must be done by qualified person(s) in accordance with all applicable codes and standards, including fire-rated construction. All metal components must be properly grounded.

All Sole Cleaners are pre-configured for 120V. It can be easily reconfigured to 240V.

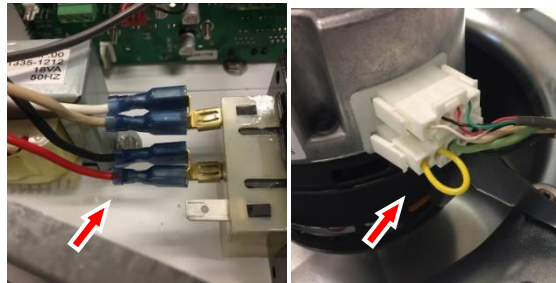

### 120V Configuration

1. **Black** and **Red** wires are connected to the same terminal.
2. Yellow Jumper Cable is installed.

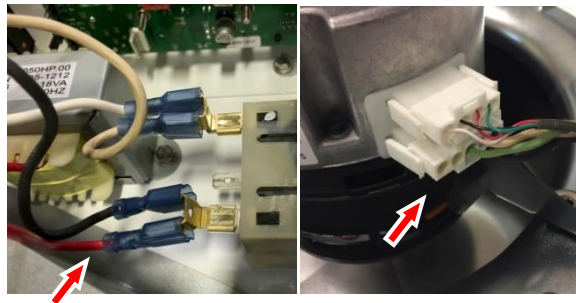

### 220V Configuration

3. **Black** and **Red** wires connect to the upper terminal as shown.
4. Yellow Jumper Cable is removed.

## 2.0 Operation

This automated adhesive mat changer will replace old used film with new material after a preset number of foot passes.

Under the cover of the right side there is the roll of new (feed) film. This film passes through the walking path on a plastic surface and is guided by two steel bars with a Teflon cover underneath for easy sliding of the film.

Under the cover of the left side (the larger housing) there is the motorized roll of used film.

### Electric Controls Operation

An infrared light sensor detects the number of people passing through the unit. See illustration.

When the counter reaches a preset count, the motor will advance the film to create a clean mat surface.

Depending on the conditions of your facilities, you may find it necessary to change this factory setting of 200 (refer to counter adjustment information below).

When the counter reaches the preset number, before energizing the motor, current passes through 2 devices:

**Timer in** (Delay timer)



Once the counter reaches the preset count (trigger count), motor activation will be delayed by this timer to allow any person on the walking pad to exit the sole cleaner safely. The system activates an audible alarm and the red status light.

### Timer Out

Displays the time the motor will be winding the film (replacing old film with new).

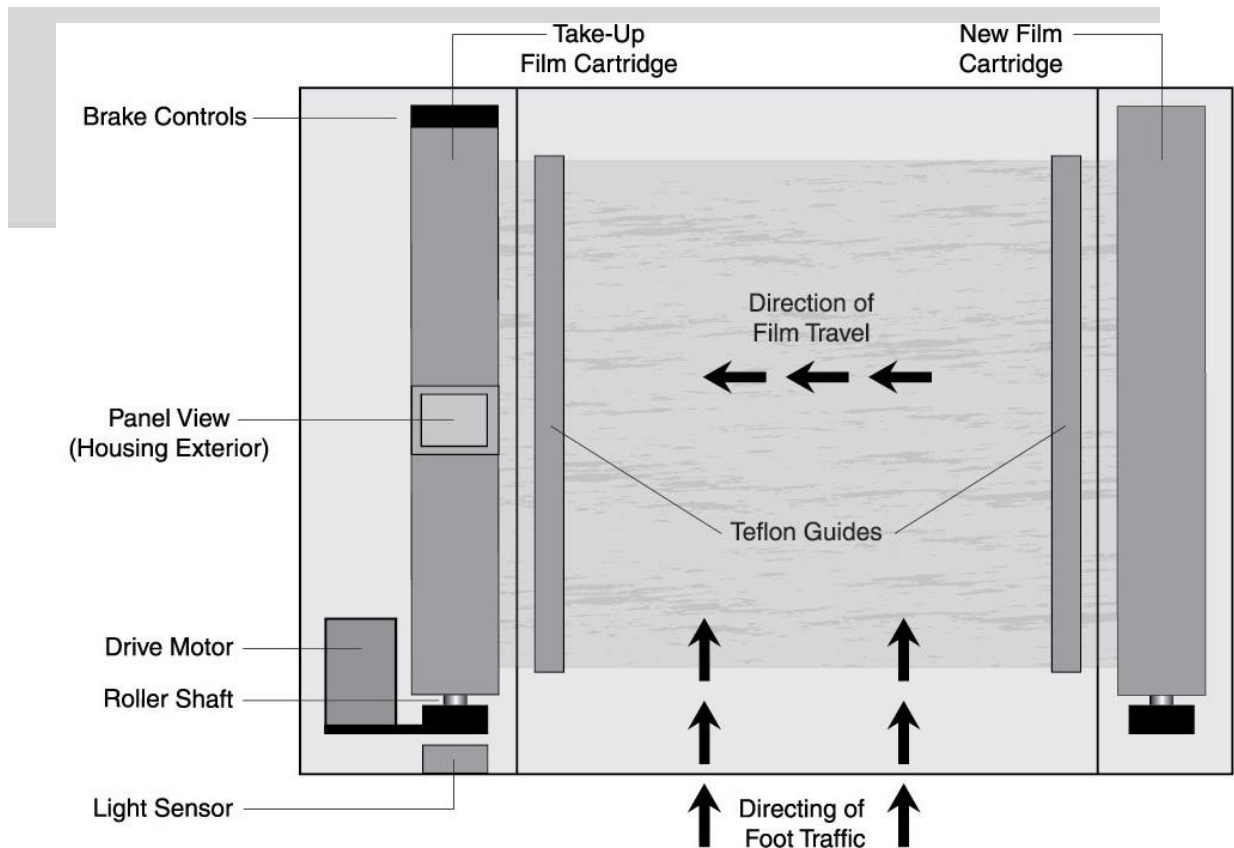

### Sole Cleaner™ Function Keys

F1: Calls up the Footpass Counter Adjust Mode to allow trigger count adjustment (default: 200)

F2: Exits the F1 (Footpass Counter) and F3 (Motor Time) Modes

F3: Calls up Motor Time Mode to adjust the film advance time (default: 8 seconds)

F4: Advances the film roller

### Changing the Footpass Counter Default:

You can change the counter set-point ("Trigger Count") from the factory setting of 200 to suit your cleanliness requirements. Lower values may be necessary if shoe soles are particularly dirty. The counter automatically resets when this value is reached and the surface is regenerated.

### To adjust the Footpass Counter setting,

1. The LCD display should indicate the number of foot passes since the last reset (i.e., since the last time the Sole Cleaner replaced the film surface).
2. Press the F1 function key to enter the Footpass Counter Adjust Mode.





3. Press the Right/Left arrow keys to select the digit to adjust (in the 1, 10, or 100 column). Use the Up/Down keys to adjust the selected digit up or down.
4. When you have established the desired footpass value, press the Return key.
5. Press F2 to exit the Footpass Counter Adjust Mode.

### Changing the Motor Time Default:

This value is the time that the motor advances the film each time the Sole Cleaner regenerates the surface. The default value of 8 seconds is typically adequate to draw the soiled film completely inside the take-up housing and replace the entire footpath with new film. A shorter motor time will reduce the amount of film that is replaced; a longer motor time increases it.

### To adjust the Motor Time setting,

1. Press the F3 function key to enter the Motor Time Adjust Mode.
2. The LCD display should indicate the current motor time (default: 8 seconds). Press the Right/Left arrow keys to select the digit to adjust (in the 1, 10, or 100 column). Use the Up/Down keys to adjust the selected digit up or down.
3. When you have established the desired motor time, press the Return key.
4. Press F2 to exit the Motor Time Adjust Mode.

### Summary of Keyboard Key Functions

**Note:** The information below is provided to explain capabilities not normally required for normal operation of the Sole Cleaner.

Count: Display Count Value

Reset: Reset /Preset count value

Function: Access Function Codes

Enter: Make Changes to Preset and Function Codes

#1: Display and change Preset

#4: Display Rate

### Roll Replacement:

When the clean film cartridge (located inside the right-side cartridge) is empty,

1. Lift the covers on both film cartridges.
2. Before removing the take-up roller with the soiled film, you must de-activate the brake by moving the "Brake Off" toggle to the off (right) position (Figure A).



Shown in Off Position

**Figure A: De-activating roller brakes.**



3. Beginning with one end of the take-up film cartridge, rotate the drive shaft till the Allen screw on the chuck faces up (see Figure B).

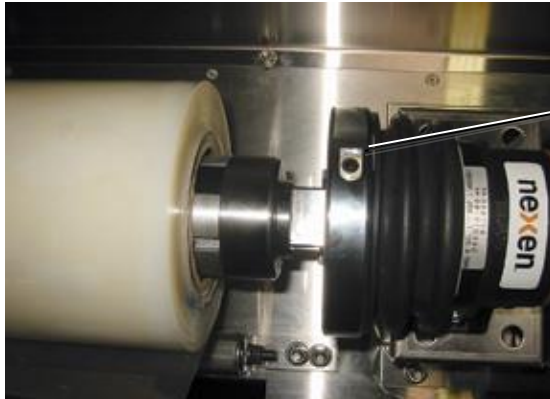

Allen Screw Facing Up

**Figure B: Positioning the Quick-Release Chuck for Roll Removal.**

4. Depress the nipple on the shaft to release air pressure, which holds the shaft against the inside of the cardboard cartridge. (See Figure C).

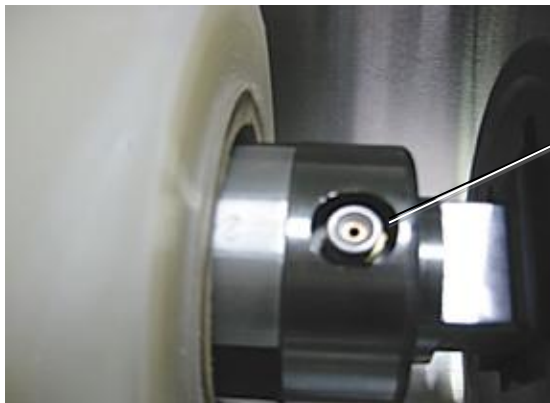

Depress Nipple

**Figure C: Bleeding the Shaft Air.**

5. Push back on the face of the quick-release chuck to disengage the chuck from the roller cartridge. (See Figures D and E).



**Figure D: Removing the Quick-Release Chuck.**



## Quick-Start Operating Guide Sole Cleaner

© Copyright 2012 Terra Universal Inc. All rights reserved. • Revised Sept. 2024 • Document No. 1800-49



**Cartridge Holder  
(Remove before Disposal  
of Dirty-Film Cartridge)**

**Figure E: Removing  
Film Cartridge.**

6. Repeat steps # 3 – 5 for the other end of the take-up roller and both ends of the new film cartridge. Be sure to remove the cartridge holders from the dirty film cartridge before disposal.
7. Place the empty roll (from the clean film side) on the drive (take-up film) side, and place the new film roll on the clean film side. You will need to insert the cartridge holders into the clean film cartridge.
8. Depress the quick-release chuck on each end to fit the holder into the chuck. You may need to adjust the holder position inside the cardboard tube to ensure a snug fit.
9. Repeat this procedure for both ends of the take-up roller.
10. Insert a standard compressed air jet to lock the cartridge holder against the cardboard cartridge by injecting air into the nipple located on the holder shaft (See Figure F).



**Figure F: Inflating the  
Cartridge Holders.**

11. Thread the leading edge of the clear film across the mat support, below the Teflon guides and onto the take-up roller (see Figure G). Use masking tape to hold the leading edge of the film along the length of the cardboard roller.

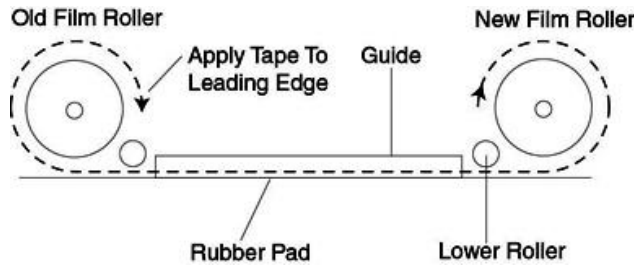

**Figure G: Positioning the New Film.**

12. Re-activate the roller brakes by flipping the “Brake Off” toggle switch back in the ON (left) position.
13. Depress the F4 function key on the Panel View momentarily to advance the film about a foot.
14. Close both covers. The quick-connect chucks will close automatically.

### Replacement Roll

**Cat. # 2010-52**

Each features 180 feet of 36"-wide 8 mil polyethylene film, yielding about 50 changes. Film is not damaged by shoes or casters and does not slip on Sole Cleaner support pad. Quantity discounts available. Weight: 39 lbs.

## 3.0 Specifications

### Electrical

115 VAC	60HZ	1 Phase
Full - Load	Current - 7.2 Amps	

### Sticky Film (typical values):

Backing:	Low-density polyethylene	
Adhesive:	Water-based acrylic	
Thickness:	8 mil	
Tensile Strength (psi)		Test Method
MD	3300	ASTM D 882
TD	2700	ASTM D 882
Elongation (%)		
MD	360	ASTM D 882
TD	540	ASTM D 882

Adhesion (oz/in)  
to stainless steel 8.0 – 12.0 PSTC-1

## 4.0 Warranty

**Products Manufactured by Terra:** Terra Universal, Inc., warrants products that it manufactures to be free from defects for a period of 12 months for parts and 90 days for labor, commencing from the date of shipment. Terra’s sole responsibility is to repair or replace, at its option, any part of the product that proves defective or malfunctioning during this time limit. In some cases, components incorporated in Terra Universal products are covered by additional warranties from component manufacturers; obtain specific information from Terra sales representatives. This warranty is void if the equipment is abused or modified by the customer, is operated outside Terra’s operating instructions or specifications, or is used in any application other than that for which it is specified. This warranty does not include routine maintenance or service procedures, breakage of quartz baths after 60 days, shipping damage, nor damage from misuse, intentional or unintentional abuse, neglect, natural disasters, or acts of God.

**Products Manufactured by Others:** Terra Universal, Inc., warrants that, to the best of its ability, Terra’s representations of products that are manufactured by others reflect the manufacturer’s representations, subject to





change without notice. Sole warranty for these products is the original manufacturer's warranty that is passed forward to the purchaser and constitutes the customer's sole remedy for these products. Detailed warranties for distributed products are available through Terra sales representatives.

**Freight Shortage or Damage:** Upon receipt of any equipment from Terra Universal, Inc., customer shall immediately unpack and inspect for damage or shortage. The customer shall not accept a damaged package or a short shipment until the carrier makes a "damage or shortage" notation on both the carrier's and customer's copy of the freight bill or delivery receipt. Service title passes when the shipment is loaded, so customer is responsible for filing and collecting a freight claim. Any replacement products must be ordered and paid for separately. For Terra's "Policy and Procedures for Returning Goods," see Terra's Internet site: [www.TerraUniversal.com](http://www.TerraUniversal.com).

Generally, customers can improve the chance of collecting on a freight claim by following these procedures: 1) formally requesting that the carrier inspect the shipment immediately upon suspecting damage or shortage to verify condition; 2) notifying the carrier upon discovery of concealed damage and requesting an inspection within 15 days of receipt, both in person or phone and following up via mail; 3) keeping the shipment as intact as possible, including retaining original packaging materials and keeping the product as close to the original receiving location as possible; 4) holding salvage for disposition by the carrier.

**All Claims:** Terra Universal expressly disclaims all other warranties, expressed or implied or implied by statute, including the warranties of merchantability or fitness for intended use. Terra Universal is not responsible for consequential or incidental damages arising out of the purchase or use of the products supplied by Terra Universal. Terra Universal is not liable for damage to facilities, other equipment, products, property or personnel of others, or of their agents, suppliers, or affiliated parties, which is caused or alleged to have been caused by products supplied by Terra Universal. In any event or series of events, Terra Universal's total liability for any and all damages whatsoever is limited to the lesser of the actual damages or the original invoice cost of the items alleged to have caused the damage. The customer's sole and exclusive remedy for any cause of action whatsoever is repair or replacement of the non-conforming products or refund of the actual purchase price, at the sole option of Terra Universal. All claims must be made in writing within 90 days of the date the product was shipped. Any claims not made within this time limit shall be deemed waived by the customer. Terra Universal is not responsible for any additional costs of repair caused by poor packaging or in-shipment damage during return.

**Warranty Returns:** All warranty returns must be authorized in advance by Terra Universal and approved under an RMA. Unless approved in advance for good reason, all returns must be in original condition, including all manuals, and must be packaged in original packaging materials. All returned goods are to be shipped to Terra Universal, freight prepaid at customer's expense. See Terra's "Policy and Procedure for Returned Goods."



**Thank you for ordering from  
Terra Universal!**