

Installation



WARNING:

Turn off the power at fuse or circuit breaker box before installation and maintenance, risk of fire/electrical shock



CAUTION:

All electrical work should be done by a qualified electrician



CAUTION:

Connect light to a 120/277 volt, 60 Hz power source. Other connections not compatible

1. Turn off the power at the main fuse/breaker box. Carefully open carton, remove panel from packaging
2. Locate fixture junction box cover and remove it using flat head screw driver (Fig. 1)



WARNING:

Ground fixture to avoid potential electric shock

3. Remove appropriate knockout(s) for power supply wiring
4. Locate space in grid location to install panel

Note: Maximum fixture weights are listed below. Ensure grid location is rated for fixture weight before moving to next step. Use cable to support fixture to structure above fixture using the circular holes in grid clips (Fig 2).

5. Pass fixture through the grid at a 45-degree angle and lay fixture onto the grid (Fig.3)
6. Grid clips are provided for additional retention to ceiling system. Orient 4 tabs on back of fixture over T-GRID by bending tabs up 90 degrees perpendicular to back of fixture. Next bend tabs 90 degrees towards T-GRID frame (Fig. 4)
7. Using the open knockout bring in supply line. Use included wire nuts (B) to attach the ground wire to the ground supply wire, the black (line) wire to the black supply wire, and the white (neutral) wire to the white supply (Fig. 5) (neutral) wire to the white supply.
8. Tuck all wires and wire nuts into fixture junction box
9. Using a Philip's head screw secure the cover on junction box
10. Connect the 2 red cables to activate the battery power (Picture.1)
11. Mount timer board on a visible surface
12. Turn on power and energize the fixture

Note: Affix the controller to the face of the light so it's accessible from within the cleanroom

Test Function:

- a. When the test function button is pressed it will light up red on the timer board. This will dim the emergency light indicating the fixture is running on battery power (Picture.3).
- b. Once timer switch is activated, timer light will turn red (Picture.4). When setting timer reaches desired time value, the timer light will turn green (Picture.5).

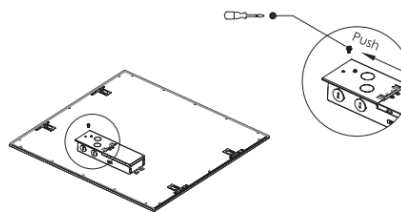

Figure 1

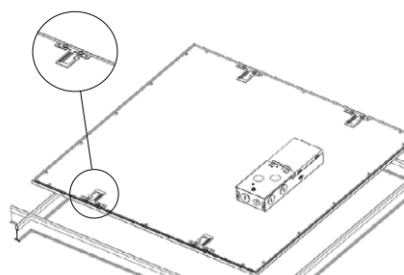

Figure 2

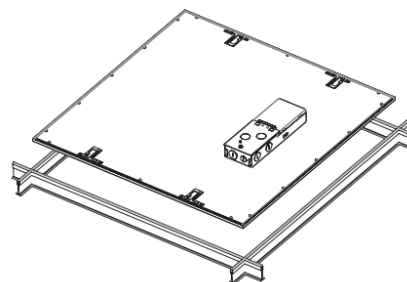

Figure 3

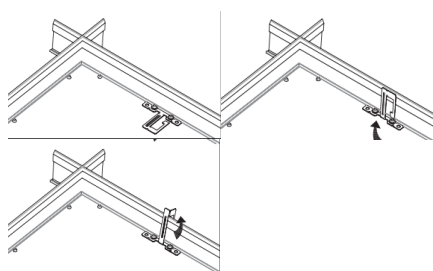

Figure 4

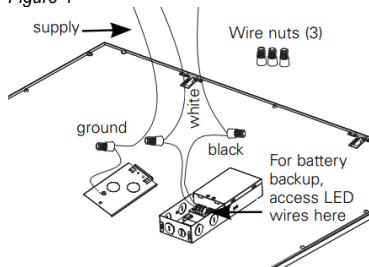

Figure 5



Picture 1



Picture 5



Picture 2

Values to Activate Timer's Rotary Switch

Default Time Value =0

0 = 2 hrs

1 = 2 hrs

2 = 4 hrs

3 = 6 hrs

... (increase in increments of 2 hrs)

E = 28 hrs

F = 30 hrs



Picture 3

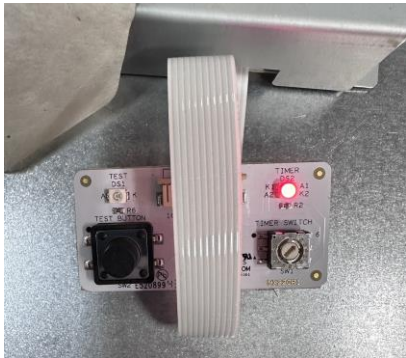

Picture 4